



Tilda®

Gardenlife

Flower Wreath Quilt Coral



Flower Wreath Quilt

(Coral colourway)

This pretty quilt is filled with flowers, thanks to the lovely fabrics from the Gardenlife and Chambray collections. The classic circular wreath design will never fail to bring delight, looking perfect wherever it is placed in the home. It uses simple techniques and one basic block, so could be completed in quite a short time. You can make a slightly different version of the quilt if you like, using a warm yellow background. There are also two pillows – see tildasworld.com for instructions.

Materials

- Fabric 1: ¼yd (25cm) – Poppies lilac (100306)
- Fabric 2: ⅜yd (40cm) – Poppies pink (100303)
- Fabric 3: ¼yd (25cm) – Bowl Peony coral (100307)
- Fabric 4: ¼yd (25cm) – Nasturtium mustard (100304)
- Fabric 5: ¼yd (25cm) – Poppies blue (100319)
- Fabric 6: ¼yd (25cm) – Striped Petunia green (100313)
- Fabric 7: ¼yd (25cm) – Bowl Peony grey green (100314)
- Fabric 8: ¼yd (25cm) – Nasturtium lavender (100308)
- Fabric 9: ¼yd (25cm) – Gardenlife plum (100310)
- Fabric 10: ¼yd (25cm) – Striped Petunia coral (100309)
- Fabric 11: ¼yd (25cm) – Bowl Peony pink (100301)
- Fabric 12: ¼yd (25cm) – Nasturtium blue (100317)
- Fabric 13: ¼yd (25cm) – Nasturtium green (100311)
- Fabric 14: ¼yd (25cm) – Poppies grey green (100312)
- Fabric 15: ¼yd (25cm) – Bowl Peony blue (100320)
- Fabric 16: 4¼yds (4m) – Chambray coral (160014)
- Fabric 17: ⅛yd (15cm) – Chambray warm yellow (160015)
- Fabric 18: ⅛yd (15cm) – Chambray lavender (160009)
- Fabric 19: ⅛yd (15cm) – Chambray cerise (160013)
- Fabric 20: ⅜yd (40cm) – Chambray sage (160011)
- Fabric 21: ⅜yd (40cm) – Chambray teal (160004)
- Fabric 22: ⅜yd (40cm) – Chambray olive (160012)
- Fabric 23: ⅜yd (40cm) – Chambray petrol (160005)
- Wadding (batting) 80in x 86in (203cm x 218.5cm)
- Backing fabric: 4⅞yds (4.4m) – Gardenlife blue (100318)
- Binding fabric ⅝yd (60cm) – Medium Dots lilac (130009)
- Piecing and quilting threads
- Quilter's ruler, rotary cutter and mat

Fabric Note

Where a long ¼yd or long ⅛yd of a yard are given in the Materials list you could use fat quarters and fat eighths instead. A fat quarter is assumed to be approximately 21in x 18in (53.3cm x 45.7cm) and a fat eighth approximately 10½in x 18in (26.7cm x 45.7cm).

Finished Size

72½in x 78½in (184cm x 200cm)

General Notes

- Fabric quantities are based on a usable width of 42in (107cm), unless otherwise stated.
- Measurements are in imperial inches with metric conversions in brackets – use only *one* system throughout (preferably inches).
- Width measurements are generally given first.
- Press all fabrics before cutting.
- Use ¼in (6mm) seams unless otherwise instructed.
- Read all the instructions through before you start.

Quilt Layout

1 The quilt uses a single large block in two different colourways, arranged in three vertical columns. Half blocks fill in the pattern at the top and bottom of the centre column of the quilt. Two different widths of sashing strips are used between the blocks. See **Fig A** for the fabrics used and **Fig B** for the quilt layout.

Fig A Fabric swatches (Flower Wreath Quilt – coral colourway)



Fig B Quilt layout (Flower Wreath Quilt – coral colourway)

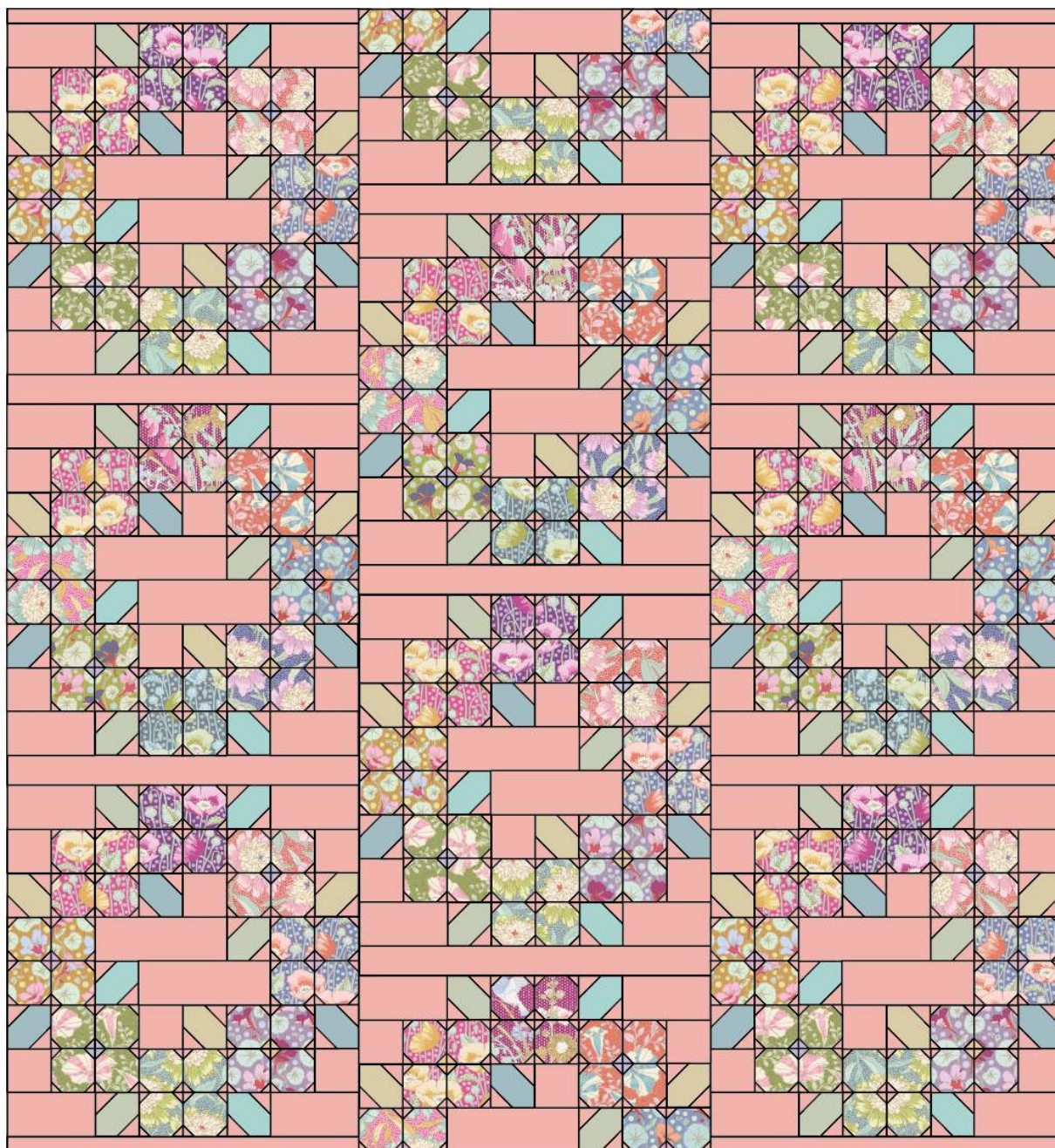

Cutting Out

2 Cut the strips for the sashing pieces first from Fabric 16 (Chambray coral), cutting the following strip sizes. (Reserve all spare fabric for pieces needed in the blocks.)

- Sashing A (horizontal pieces between the blocks) – cut seven pieces $24\frac{1}{2}\text{in} \times 2\frac{1}{2}\text{in}$ (62.2cm x 6.4cm).
- Sashing B (horizontal pieces at the top and bottom of the quilt) – cut four pieces $24\frac{1}{2}\text{in} \times 1\frac{1}{2}\text{in}$ (62.2cm x 3.8cm).

3 For a *single* Block 1, cut the following pieces. Refer also to **Fig C** for the sizes of the pieces and **Fig D** for the fabric positions. Repeat the cutting for five of Block 1 in total.

- From each print Fabric 1, 2, 3, 4, 5, 6, 7 and 8, cut four $3\frac{1}{2}$ in (9cm) squares (for a total of thirty-two squares).
- From each Chambray Fabric 20, 21, 22 and 23 cut three $3\frac{1}{2}$ in (9cm) squares (for a total of twelve squares).
- From Fabric 16 cut the following pieces.
 - Six $3\frac{1}{2}$ in (9cm) squares.
 - Four $6\frac{1}{2}$ in x $3\frac{1}{2}$ in (16.5cm x 9cm) corner rectangles.
 - Two $9\frac{1}{2}$ in x $3\frac{1}{2}$ in (24.1cm x 9cm) centre rectangles.
 - Twenty-four 2in (5.1cm) squares.
 - 104 $1\frac{1}{4}$ in (3.2cm) squares.
- From each of Fabric 17, 18 and 19 cut eight $1\frac{1}{4}$ in (3.2cm) squares.

4 For a *single* Block 2, cut the following pieces. Refer also to **Fig C** for the sizes of the pieces and **Fig D** for the fabric positions. Repeat the cutting for three of Block 2 in total.

- From each print Fabric 2, 9, 10, 11, 12, 13, 14 and 15, cut four $3\frac{1}{2}$ in (9cm) squares (for a total of thirty-two squares).
- From each Chambray Fabric 20, 21, 22 and 23 cut three $3\frac{1}{2}$ in (9cm) squares (for a total of twelve squares).
- From Fabric 16 cut the following pieces.
 - Six $3\frac{1}{2}$ in (9cm) squares.
 - Four $6\frac{1}{2}$ in x $3\frac{1}{2}$ in (16.5cm x 9cm) corner rectangles.
 - Two $9\frac{1}{2}$ in x $3\frac{1}{2}$ in (24.1cm x 9cm) centre rectangles.
 - Twenty-four 2in (5.1cm) squares.
 - 104 $1\frac{1}{4}$ in (3.2cm) squares.
- From each of Fabric 17, 18 and 19 cut eight $1\frac{1}{4}$ in (3.2cm) squares.

Fig C Cut pieces needed for the blocks

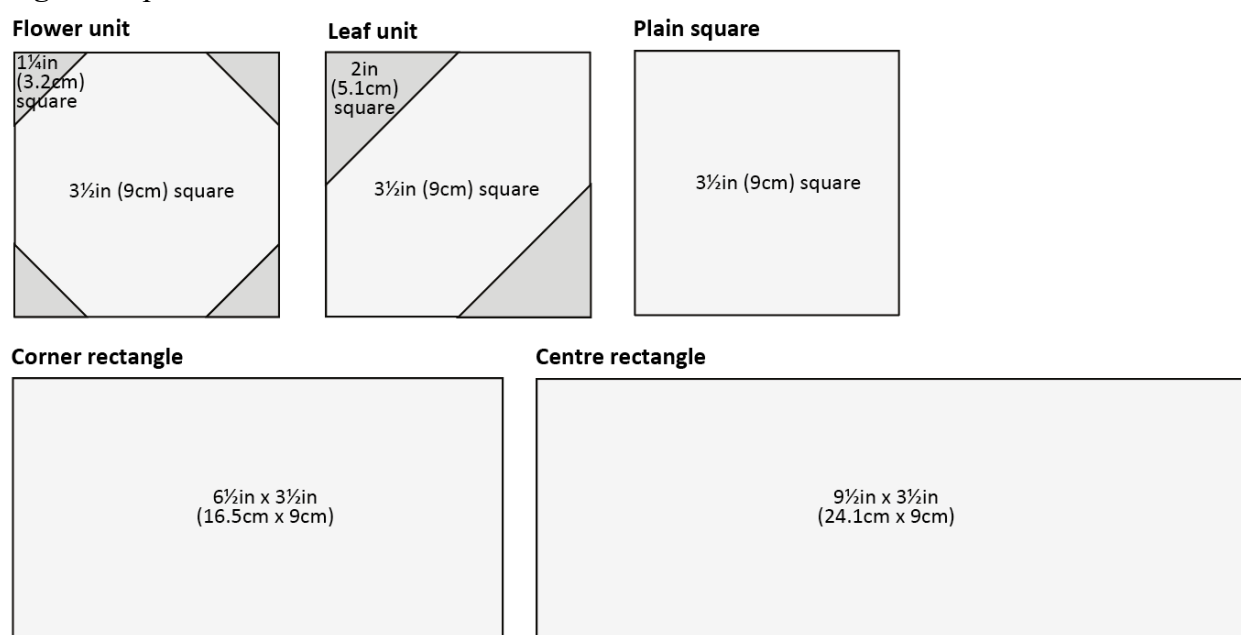
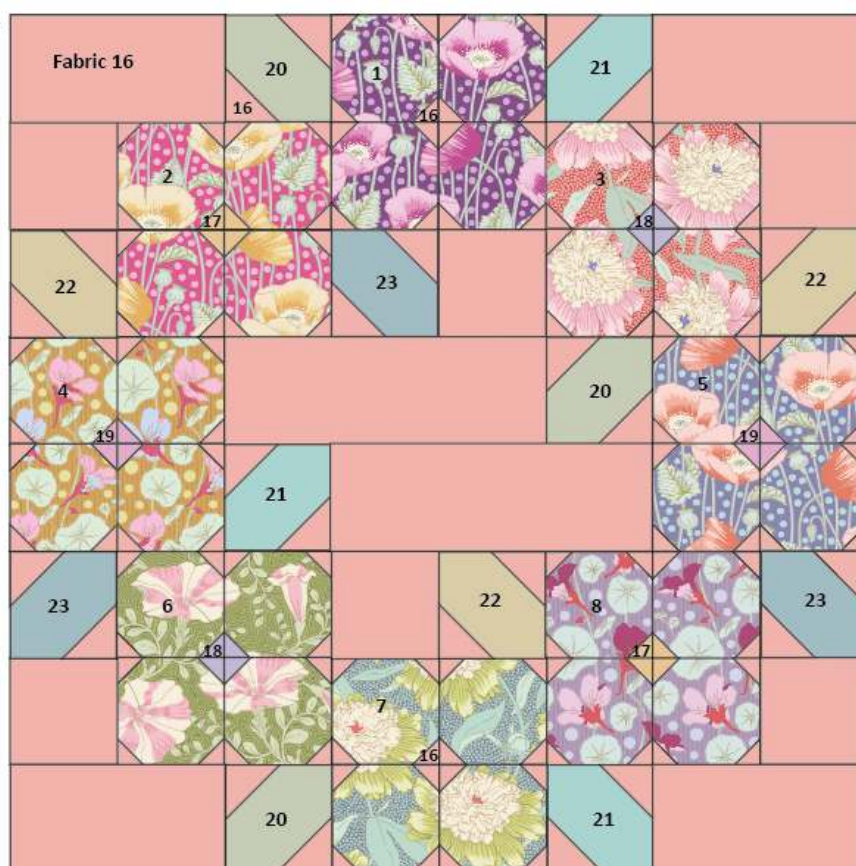
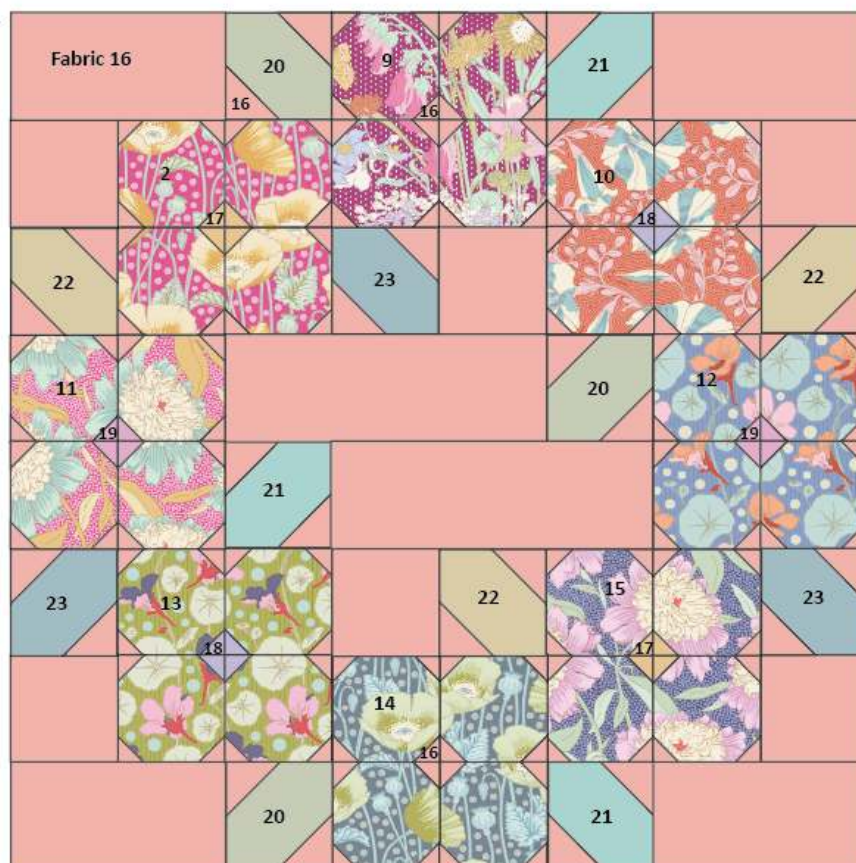

Fig D Fabrics used for the blocksNumbers identify the fabrics used (see also **Fig A**)**Block 1** –
make 5**Block 2** –
make 3

5 For the *bottom* half of Block 1, cut the same pieces as for the whole block but *only* the pieces needed for the bottom half – see **Fig E**.

6 For the *top* half of Block 2, cut the same pieces as for the whole block but *only* the pieces needed for the bottom half – see **Fig E**.

Fig E Fabrics used for the half blocks

Block 1 bottom half – make 1

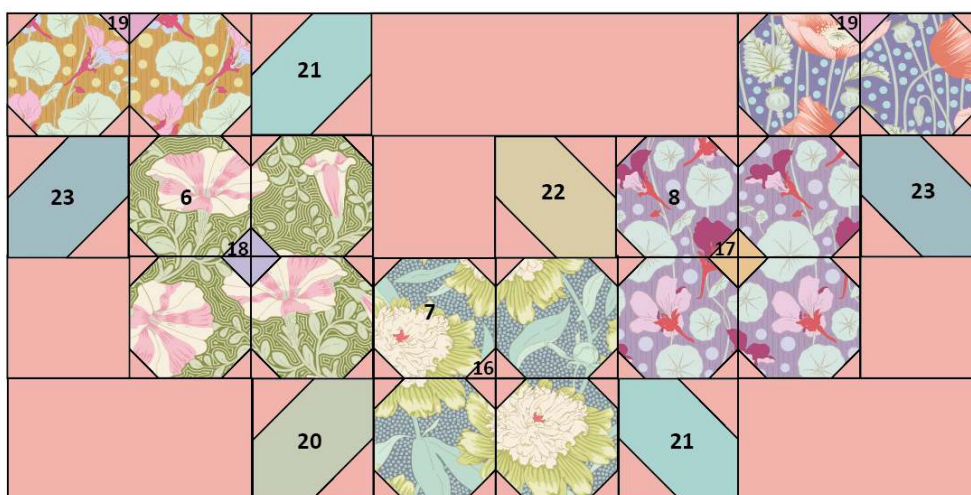

Block 2 top half – make 1



7 Cut the backing fabric into two pieces 86in (218.5cm) x width of fabric. Sew them together along the long side and press the seam open. Trim to a piece about 80in x 86in (203cm x 218.5cm).

8 Cut the binding fabric into eight strips 2½in (6.4cm) x width of fabric. Sew them together end to end and press seams open. Press in half along the length, wrong sides together.

Making a Block

9 Block 1 and Block 2 are made the same way but with different print fabrics. Block 1 will be described in detail. The leaf units and the flower units both use a corner triangle technique.

10 Sewing a leaf unit Following **Fig F**, take a Chambray $3\frac{1}{2}$ in (9cm) square (see **Fig D** for the relevant colour) and two 2in (5.1cm) squares of Fabric 16. Pencil mark a diagonal line on the wrong side of the small squares. Place the squares right sides together with the larger square, aligning them in two opposite corners as shown, and with the marked lines in the directions shown. Sew along the marked lines. Trim off excess fabric $\frac{1}{4}$ in (6mm) outside the sewn lines and then press the triangles outwards. Check the unit is $3\frac{1}{2}$ in (9cm) square.

Fig F Sewing a leaf unit

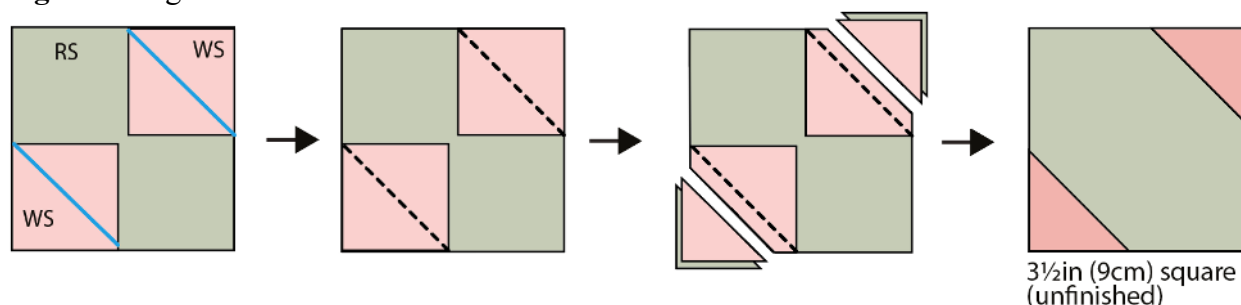

11 All of the leaf units are made this way. For the whole quilt you will need twenty-seven each of four different colour combinations – see **Fig G**.

Fig G Making all the leaf units

Make 27 of each of these leaf units

In the quilt, some leaf units are rotated to point the opposite way

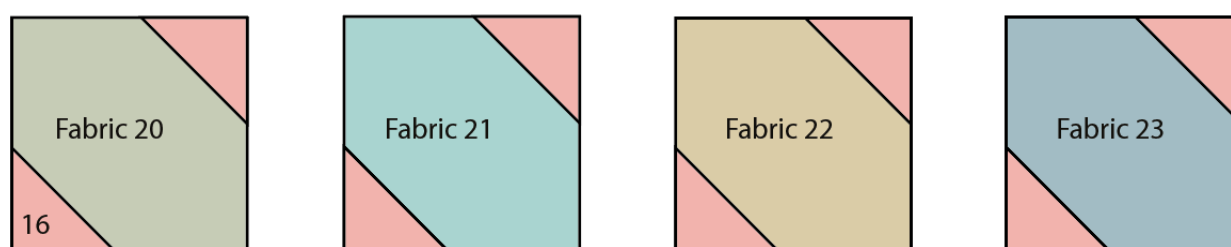

12 Sewing a flower unit These units use the same technique but with print fabrics for the $3\frac{1}{2}$ in (9cm) squares and with smaller corner pieces ($1\frac{1}{4}$ in/3.2cm). Note too, that in most of the units one corner is a different fabric – follow **Fig D** to select the correct pieces. **Fig H** here shows the process for adding the four corners. Once the corners are added and the triangles are pressed outwards, check the unit is $3\frac{1}{2}$ in (9cm) square.

Fig H Sewing a flower unit

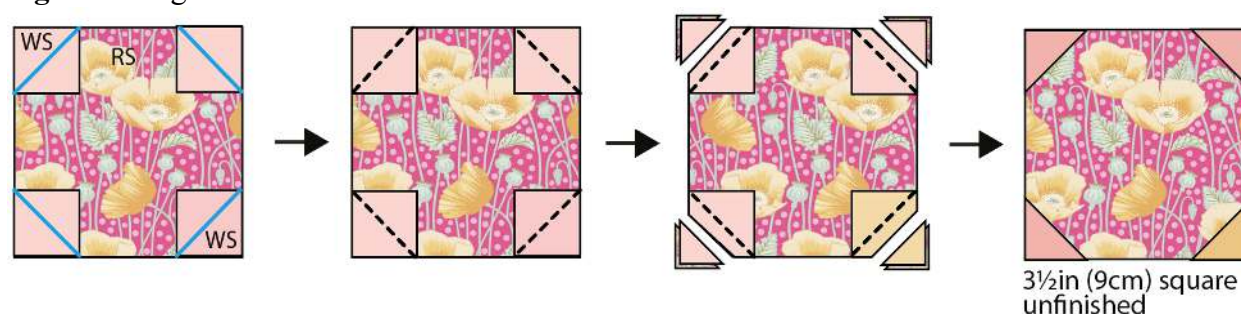

13 Follow **Fig D** carefully to make the correct numbers of flower units. You will see that they occur in groups of four.

14 Sewing a block together When all of the units have been made for one block, arrange the units and plain pieces as shown in **Fig I** (this diagram shows Block 1). Take care to arrange the leaf units so they point in the correct direction. The flower units should have matching triangles at their centres.

15 Sew the units together in rows. Press the seams of alternate rows in opposite directions. You can sew the rows into pairs if you like, as shown in the diagram. Now sew the rows together, matching seams neatly. Press the block and check it is 24½in (62.2cm) square.

16 Repeat the whole process to make five of Block 1 in total and then make three of Block 2.

Fig I Sewing a block together

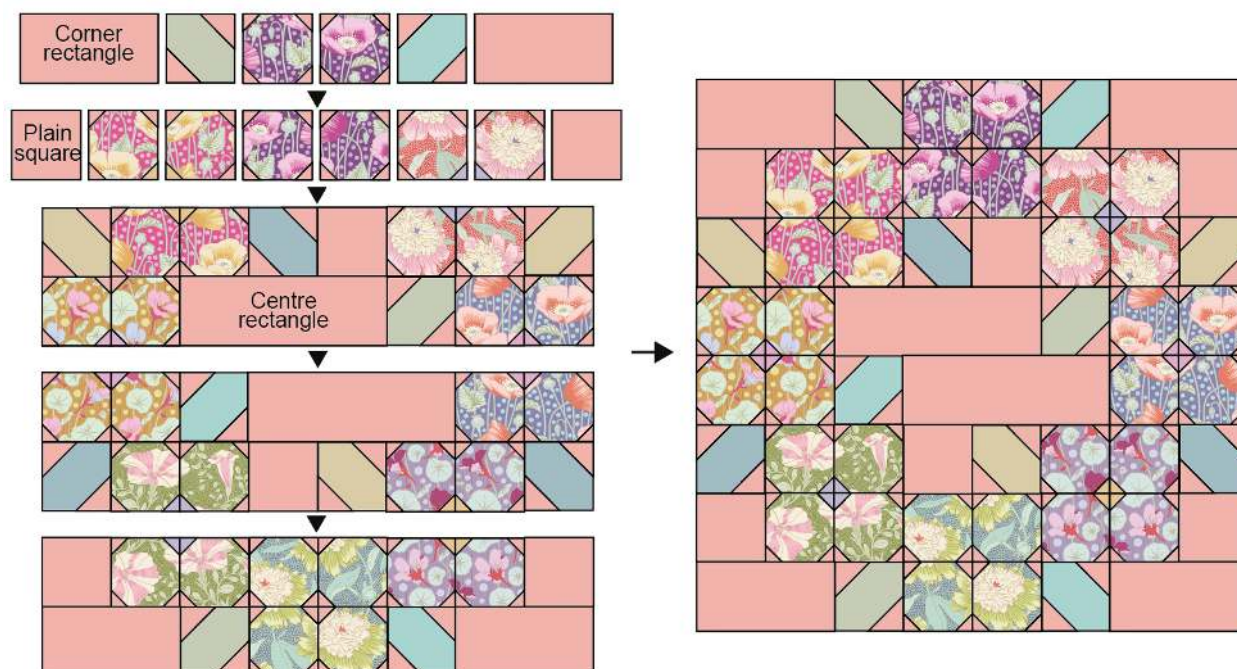

Making the Half Blocks

17 The half blocks are made in the same way as the whole blocks, except that you only need to make the bottom half of a Block 1 and the top half of a Block 2 – see **Fig E** for the fabric positions and the layout of these half blocks.

Assembling the Quilt

18 When all of the blocks are made, assemble the quilt in three columns, laying out the blocks and half blocks as shown in **Fig J**. You will see that Block 1 and Block 2 alternate. Place the Sashing A and Sashing B strips between the blocks as shown in the diagram. Sew each column together, pressing the seams in one direction. Now sew the columns together and press.

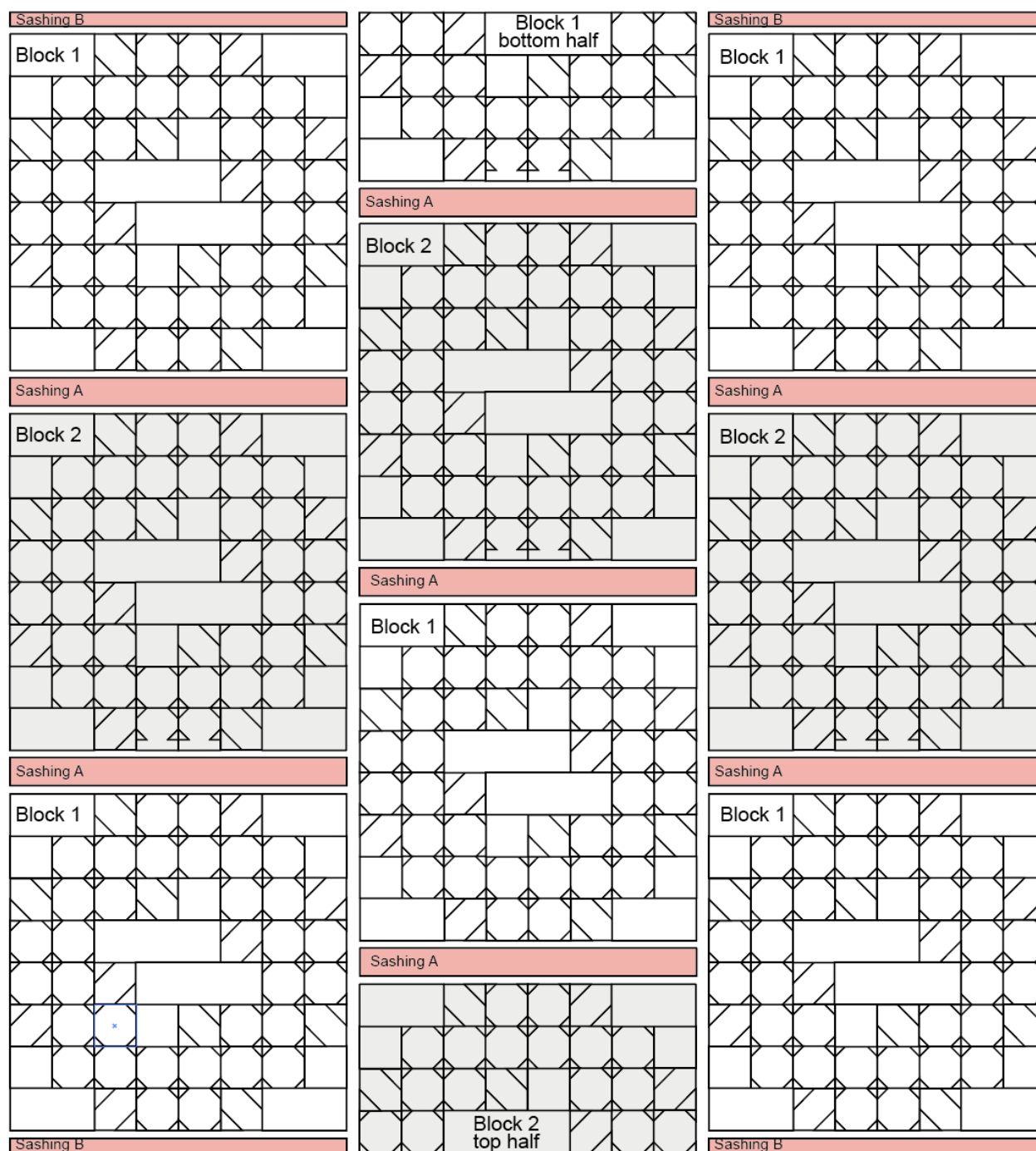
Fig J Assembling the quilt

Quilting and Finishing

19 If you are quilting the quilt yourself you now need to make a quilt sandwich – you can do this in various ways, as follows.

- Use large stitches to tack (baste) a grid through the layers of the quilt in both directions, with lines about 4in (10cm) apart.
- Use pins or safety pins to fix the layers together.
- Use fabric glue sprayed onto the wadding (batting) to fix the layers together.

If you are sending the quilt off to be commercially long-arm quilted you won't need to make a sandwich, as this is done when the quilt is mounted on the machine. When the layers of the quilt are secured you can quilt as desired.

20 When all quilting is finished, square up the quilt ready for binding.

21 Use the prepared double-fold binding strip to bind your quilt. Sew the binding to the quilt by pinning the raw edge of the folded binding against the raw edge of the quilt. Don't start at a corner. Using a $\frac{1}{4}$ in (6mm) seam, sew the binding in place, starting at least 6in (15.2cm) away from the end of the binding. Sew to within a $\frac{1}{4}$ in (6mm) of a corner and stop. Take the quilt off the machine and fold the binding upwards, creating a mitred corner. Hold this in place, fold the binding back down and pin it in place. Begin sewing the $\frac{1}{4}$ in (6mm) seam again from the top of the folded binding to within $\frac{1}{4}$ in (6mm) of the next corner and then repeat the folding process. Do this on all corners. Leave a 6in (15.2cm) 'tail' of unsewn binding at the end.

22 To join the two ends of the binding, open up the beginning and end of the binding tails, lay them flat and fold the ends back so the two ends touch. Mark these folds by creasing or with pins – this is where your seam needs to be. Open out the binding and sew the pieces together at these creases. Trim off excess fabric and press the seam. Re-fold the binding and finish stitching it in place on the front of the quilt.

23 With the quilt right side up, use a medium-hot iron to press the binding outwards all round. Now begin to turn the binding over to the back of the quilt, pinning it in place. Use matching sewing thread and tiny stitches to slipstitch the binding in place all round, creating neat mitres at each corner. Press the binding and your charming quilt is finished.